

Leica DISTO™ with Bluetooth Smart usage on Windows 8

V 1.0

December 2013

- when it has to be **right** 

The Leica DISTO™ devices with Bluetooth®



Leica DISTO™ D3a BT (D330i)
Bluetooth® 2.1

→ Requires **SPP** support



Leica DISTO™ D8
Bluetooth® 2.1

→ Requires **SPP** support



Leica DISTO™ D510
Bluetooth® Smart

→ Requires **Bluetooth® 4.0**



Leica DISTO™ D810 touch
Bluetooth® Smart

→ Requires **Bluetooth® 4.0**



Overview DISTO™ compatibility

	Availability	Windows 7 	Windows 8 	Windows Mobile 6.5	Android 	iOS 
Leica DISTO™ sketch *)		-	-	-	-	
Leica DISTO™ sketch *)		-	-	-		-
Leica DISTO™ transfer **)		-	-	-		-
Leica DISTO™ transfer PPC ***)	www.disto.com 	-	-		-	-
Leica DISTO™ transfer PC ***)	www.disto.com 			-	-	-
Keyboard Mode ***)	No installation required	-		-	-	

*) Draw sketches and export these as pdf file or the measurements via csv file

***) Integrated Excel application to send values to a spread sheet. Also measurements are transferred into the clipboard to be pasted at any position in an application

****) DISTO™ connects as a keyboard and sends data right to cursor position in any application or software

*****) In development, planned for January 2014

Prolog

This presentation should provide further advice on how to use the Leica DISTO™ with Bluetooth® Smart. Also the corresponding Apps for iOS and Android are described in this document.

For further information regarding using **Bluetooth® 2.1** please use the document at following link:

http://ptd.leica-geosystems.com/en/Leica-DISTO-D8_78069.htm

→ *Leica DISTO™ transfer - How to connect*

Leica DISTO™ Bluetooth Smart



Getting started

- when it has to be **right** *Leica*
Geosystems

General

Bluetooth® Smart

- Bluetooth® Smart is compatible with Bluetooth® 4.0 or Bluetooth® Smart Ready devices
- Bluetooth® Smart has very low power consumption why it is by default switched on

Leica DISTO™ D510 Bluetooth® Smart

- The Bluetooth® can be switched off in the Settings of the Leica DISTO™ D510
- The Leica DISTO™ D510 only supports the connection to iOS or Android 4.3 Apps



Press '=' to switch on or off

Leica DISTO™ D810 touch Bluetooth® Smart

- The Bluetooth® can be switched off in the Settings of the Leica DISTO™ D810 touch



Leica DISTO™ D810 touch Bluetooth® Smart

- The Leica DISTO™ D810 touch provides 3 different modes for use with Bluetooth®

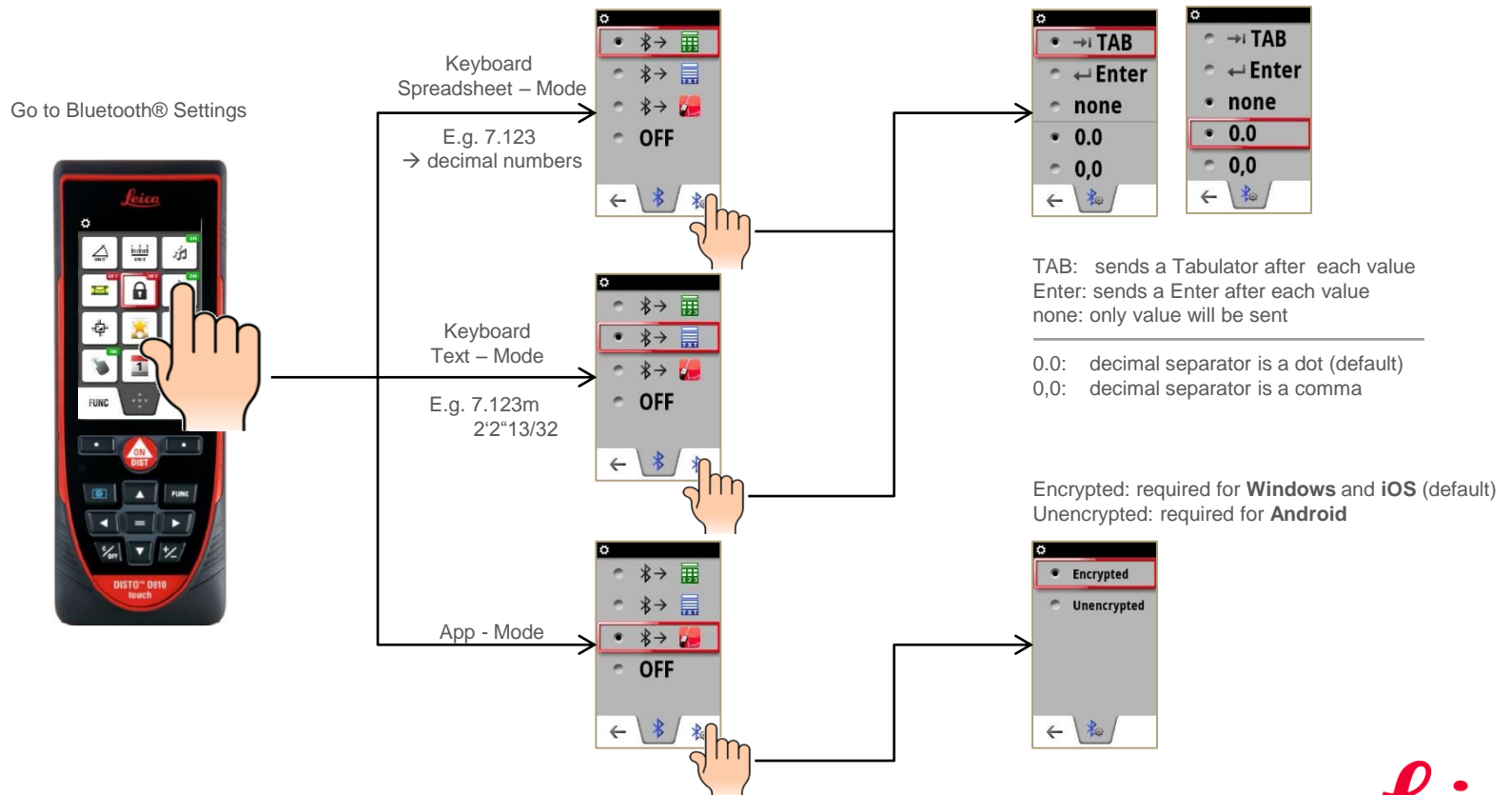

- when it has to be **right**

Keyboard Mode

Windows 8 or higher 

Getting started

- when it has to be **right** 

Keyboard Mode for Windows 8

How to start

- This mode is only supported by the **Leica DISTO™ D810 touch**
- Please use the Bluetooth® manager to pair the devices. Once the Windows 8 device and the Leica DISTO™ are paired they will immediately connect if both are switched on.
- The Leica DISTO™ will be considered as a keyboard. So by sending a measurement the Windows 8 device believes you are writing the value on a keyboard.

Keyboard Mode for Windows 8

How to start

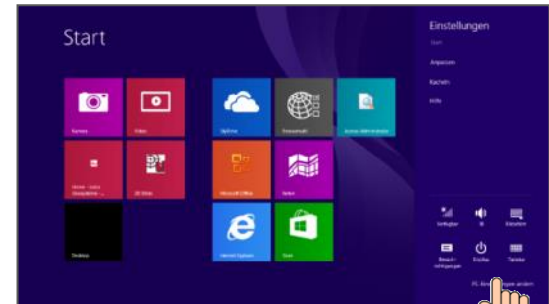

Select „Change PC Settings“

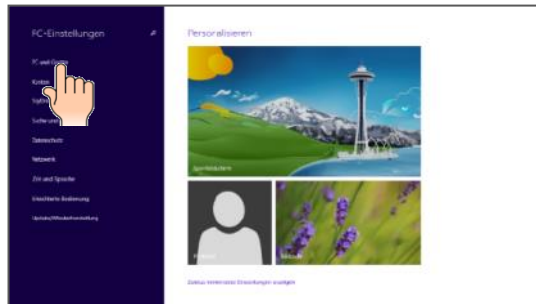

Select „Devices“

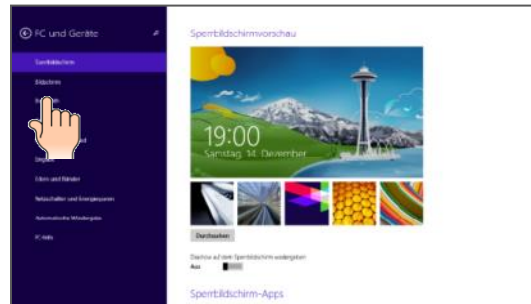

Select „Bluetooth“

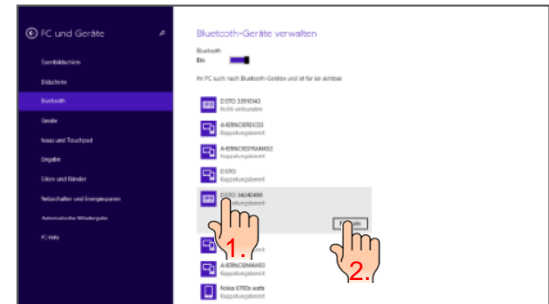

Click on device and select „Pair“

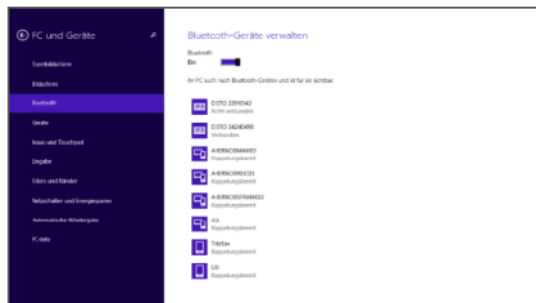

12 Instrument should be listed as paired device

Keyboard Mode for Windows 8

How to start

- You need to either set the DISTO™ D810 touch to following modes (see also page 9 of this presentation)
 - Spreadsheet mode:
Use for sending decimal values without unit for further calculation
 - Text mode:
Use for sending values an on the device display incl. unit for documentation



Keyboard Mode for Windows 8

How to send data and navigate in a Program

- After the devices are connected the favorite keys will change for sending measurement values or navigation

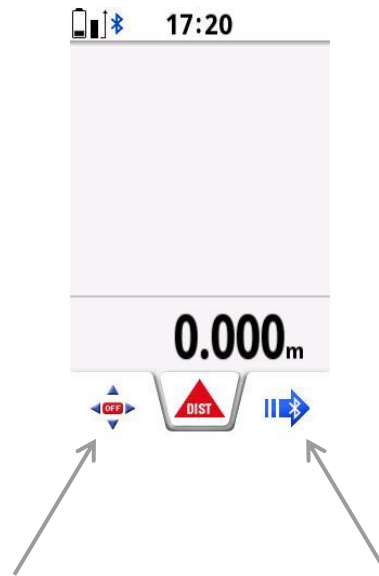

If switched on the Arrow keys on the DISTO™ can be used for navigation on e.g. Excel

Sends the actual value in the main-line of the DISTO™ to the current cursor position of any App

Keyboard Mod for Windows 8

Good to know

- If you want to unpair device to prevent automatic detection either switch off Bluetooth® at DISTO™ or press „Remove device“ in the settings of the Windows 8 device.
To Remove a device in Windows 8 proceed to the same menu like for adding a device.

Please
Note

When a Leica DISTO™ D810 touch is already paired with one iOS or Windows 8 device it cannot be paired with a second device at the same time, it needs to be unpaired first!